

belastingen per m2 dakvlak

Eigen gewicht: 0,24kN
 Pannen: 0,60kN
 Sneeuw/wind: 0,63kN

Totaal: 1,47kN

Veiligheidsklasse = 2
 $1,47\text{kN} * 1,3 = 1,91\text{kN}$

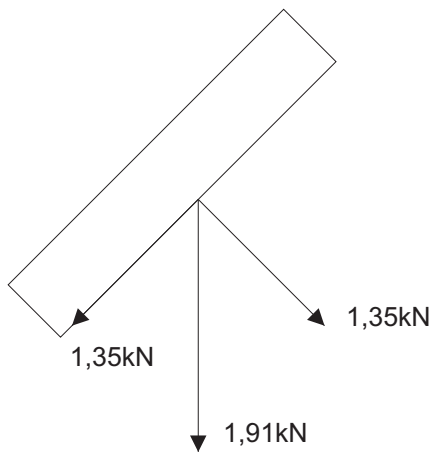

Totale dakvlak:

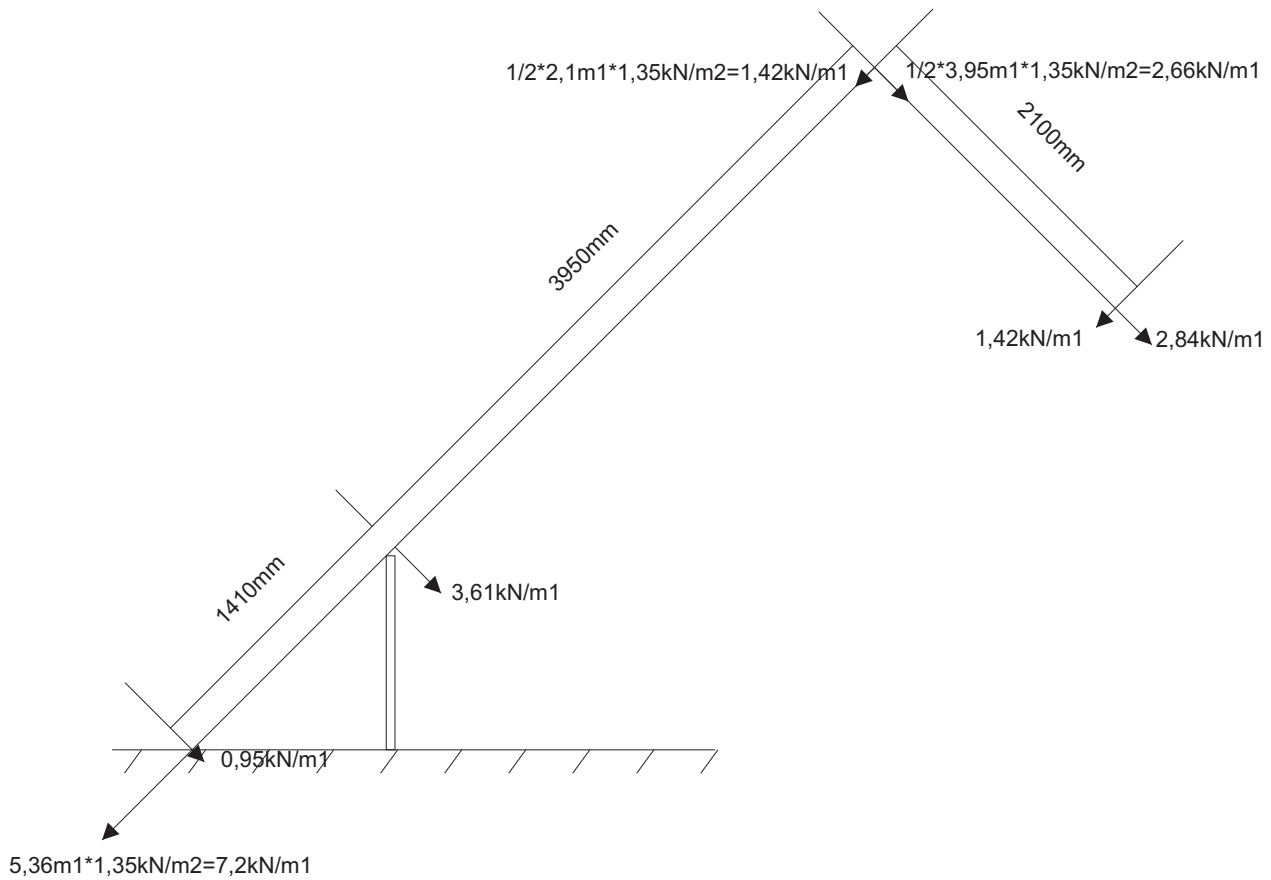

Krachten boven nieuwe sparing:

